

Butterball VALVE

BB2 SERIES

1/4"-2" 175 PSI (1207kPa)

THREADED END ONLY

WW-V-1967

THREADED END - FIG# BB2-100
SOLDER END - FIG# BB2-350



RATINGS

- 175 psig WOG
- CSA (AGA/CGA) & UL Ratings^{(1)(*)}
- Vacuum to 29"
¹(Except 1/4" & 3/8" Threaded end)

FEATURES

- Full Port Design
- Full Flow, High Cv
- One Piece Bronze Body*
- Stainless Steel stem and disc
- Viton Seal
- Excellent throttling characteristics⁽³⁾
- Requires no system pressure to seal
- 30°F to 275°F Temperature Range

APPLICATIONS

- Natural Gas Shut-off*
(1/2" psi and 5 psi)
- LP Gas Shut-off*
- Gas and Air Systems
- Fuel Oil (Types 1-6)*
- Oil Systems*
- Liquid Service including water⁽²⁾
- Throttling, Balancing & Shut-off⁽³⁾
- Vacuum Service

* Applies to BB2-100 Series Threaded End only

⁽²⁾ Do not use on hot water over 120° F

⁽³⁾ Do not throttle or leave in the near closed position as seal damage may result.

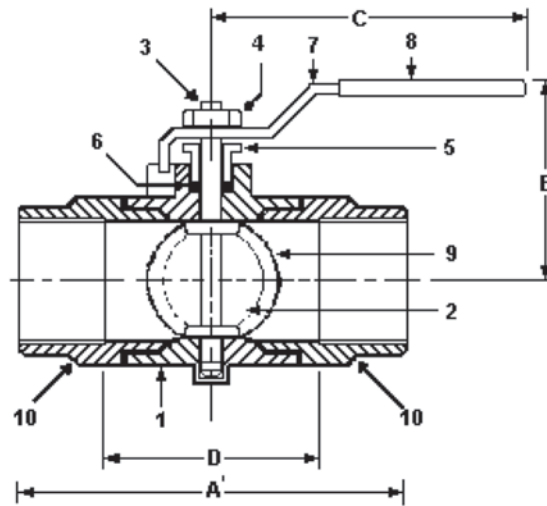
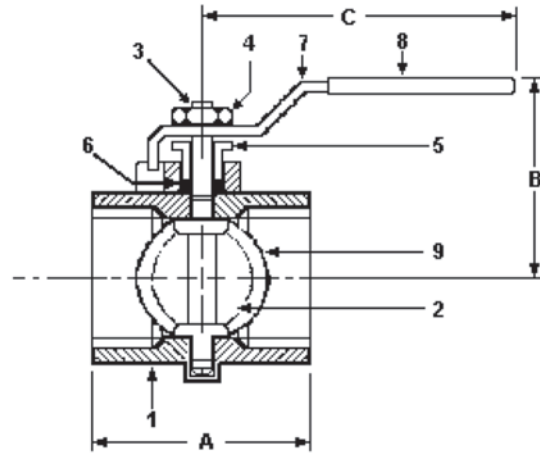

MATERIALS

ITEM	PART	MATERIALS	ASTM SPEC.
1	Body	Bronze	ASTM-B584
2	Disk	Stainless Steel	Type 304
3	Stem	Stainless Steel	Type 303
4	Hex Nut	Stainless Steel	Type 302
5	Gland	Rod Bronze	CA-360
6	Packing	Nylon	
7	Handle	Steel w/ Zinc Plating	
8	Flat Grip	Vinyl	
9	Disc Seat	Viton	
10	Tailpiece	3/8" - 3/4" Brass Rod	ASTM-B16
		1"-2" Bronze	ASTM-B584

DIMENSIONS

	UNITS	1/4"	3/8"	1/2"	3/4"	1"	1-1/4"	1-1/2"	2"
A	INCHES	2.25	2.38	1.88	2.00	2.13	2.63	2.88	3.25
	mm	57.2	60.3	47.6	50.8	54.0	66.7	73.0	82.6
A ¹	INCHES	NA	2.38	2.50	3.13	3.63	4.38	4.88	5.63
	mm		60.3	63.5	79.4	92.1	111.1	123.8	142.9
B	INCHES	1.50	1.50	1.50	1.56	1.75	2.19	2.31	3.63
	mm	38.1	38.1	38.1	39.6	44.5	55.63	58.7	92.2
C	INCHES	3.50	3.50	3.50	3.50	3.50	5.00	5.00	5.00
	mm	88.9	88.9	88.9	88.9	88.9	127	127	127
D	INCHES	NA	1.63	1.50	1.63	1.81	2.44	2.69	2.94
	mm		41.4	38.1	41.4	46.0	62.0	68.3	74.7
Cv			10	13	25	43	85	112	180
Torque	in/lb	18	18	18	22	35	50	70	120
Weight (lbs)	BB2-100	0.6	0.6	0.5	0.7	0.8	1.0	1.5	3.0
	BB2-350	NA	0.5	0.5	0.6	1.0	1.6	2.0	3.7

Rev. 3

The information presented on this sheet is correct at the time of publication. Milwaukee Valve reserves the right to change design, and/or material specifications without notice. For the Installation, Operation and Maintenance Manual (IOM) see the engineering section on our website. For the most current information access www.milwaukeevalve.com

